

**SAPF/SCIF Wall Types**  
 Source: IC Tech Spec – for ICD/ICS 705 VERSION 1.4

**Wall A - Suggested Standard Acoustic Wall Construction**

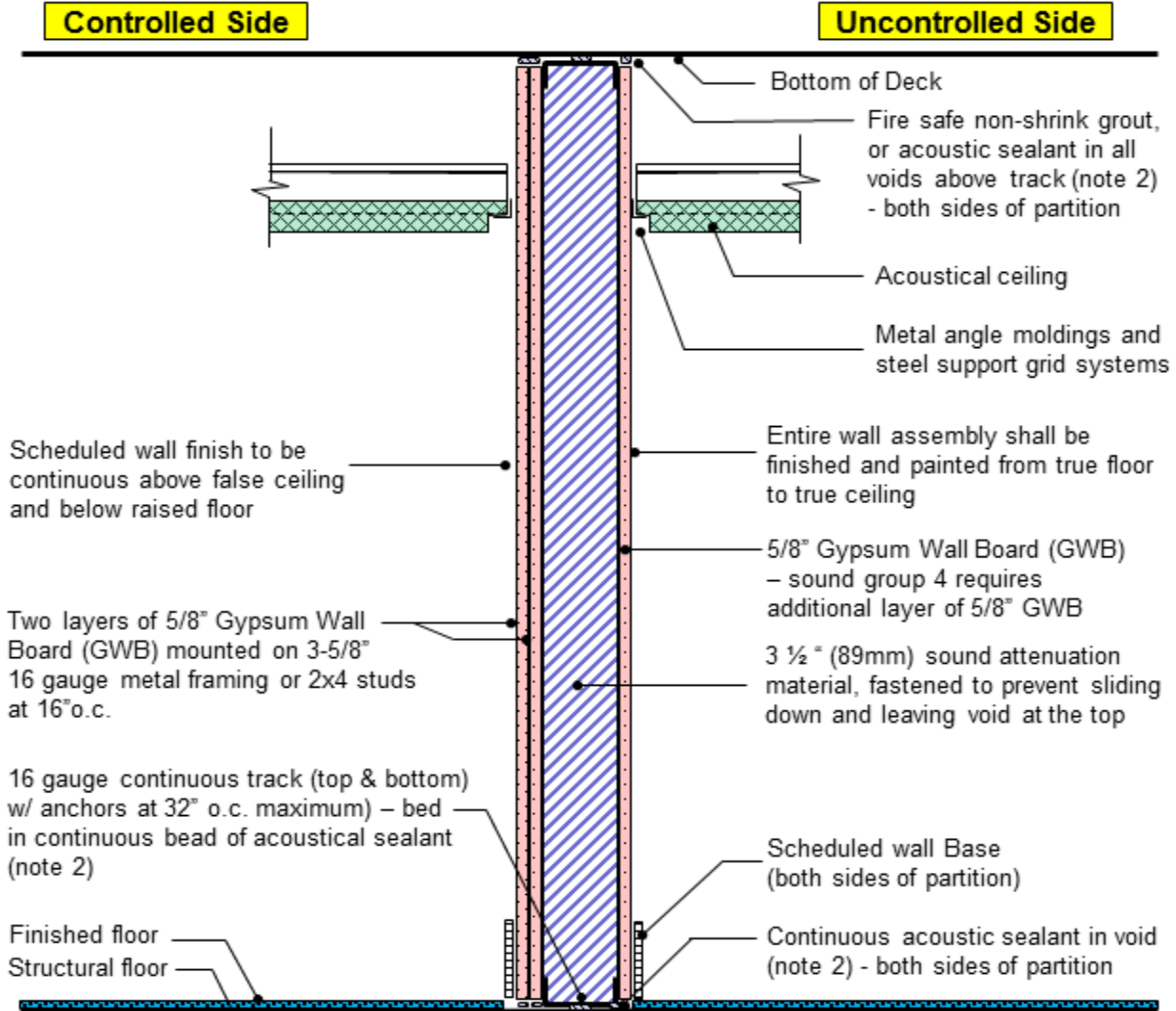

Notes:

- 1 CTTA recommended countermeasures (foil backed GWB or layer of approved Ultra Radiant R-Foil) shall be installed IAW best practices for architectural Radio Frequency (RF) shielding. Foil shall be located between the two layers of GWB.
- 2 Partition shall be sealed continuously with acoustical sealant whenever it abuts another element (e.g., wall, column, mullion, etc.)
- 3 Any electrical or communications outlets required on the perimeter wall shall be surface mounted.



## Wall C - Suggested Wall Construction for Plywood

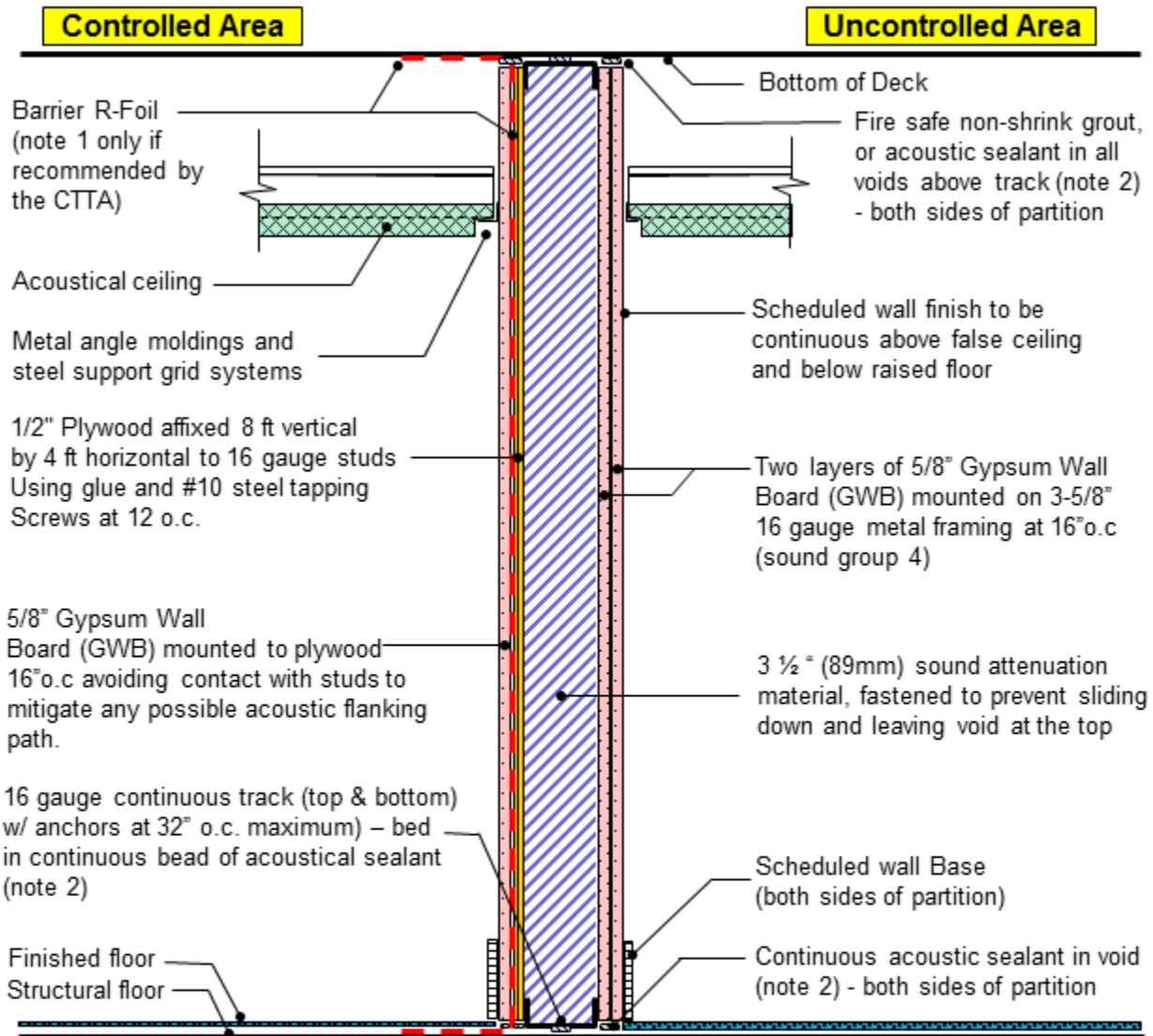

**Notes:**

- 1 CTTA recommended countermeasures (foil backed GWB or layer of approved Ultra Radiant R-Foil) shall be installed IAW best practices for architectural Radio Frequency (RF) shielding. Foil shall be located between the layer of plywood and GWB.
- 2 Partition shall be sealed continuously with acoustical sealant whenever it abuts another element (e.g., wall, column, mullion, etc.).
- 3 Any electrical or communications outlets required on the perimeter wall shall be surface mounted.